

# ORTHODONTIC

## Product Catalogue

- for aesthetics and biocompatibility -



**GESTENCO**





# Orthodontic Product Catalogue

- for aesthetics and biocompatibility -

# THE COMPANY

goals and visions



Gestenco International AB has over the years developed and produced many aesthetic orthodontic appliance systems. Several independent "in vitro" and "in vivo" university studies have verified our products to be the best of its kind in the marketplace today. Subsequently they have been very well received and used for many years by doctors all over the world.

We believe that our appliances have a great advantage to other materials when it comes to things like:

- aesthetics
- biocompatibility
- allergies
- less pain to the patient
- no damage to the enamel
- easy bonding and debonding
- no discolouration
- very low friction
- preventing rootresorption - If excessive torque is applied to the wire, the archwire slot will "give in" due to the relative elasticity of the bracket material! The bracket saves the root and no "overtorque" and subsequent rootresorption is possible.

We have tooth-coloured archwires to go with the brackets in order to get a complete aesthetic appliance. They will also protect a patient with a nickel-allergy from getting in touch with the bare wire.

Our newly developed Oyster ESL bracket is a one of a kind in the sense of being the only aesthetic self-ligating bracket available in the market today.

SmartBond and SmartBond LC are unique and true one-step bonding materials that works in a wet or dry environment and bonds all kinds of bracket materials like metal, ceramic and plastic without additional conditioners.

Our appliances do not need any metal reinforcement due to the very special polymers that we use. In modern orthodontics with soft NiTi wires, doctors tend to fill out the archwire slot much earlier in treatment. Hence there is no need for any extra reinforcement of the slot as the rectangular or square archwires will have full engagement most of the time.

# TABLE OF CONTENTS

<b>OYSTER</b>	<b>6</b>
<b>IMAGE</b>	<b>10</b>
<b>SOLO</b>	<b>13</b>
<b>BLONDE</b>	<b>14</b>
<b>BLONDE RAINBOW</b>	<b>16</b>
<b>PHANTOM</b>	<b>18</b>
<b>VITRINE</b>	<b>20</b>
<b>BITE BUMPER</b>	<b>22</b>
<b>LIP AND CHEEK RETRACTOR</b>	<b>23</b>
<b>SMARTBOND</b>	<b>24</b>
<b>SMARTBOND LC</b>	<b>26</b>
<b>IMAGINATION</b>	<b>28</b>
<b>SUPPLIES</b>	<b>30</b>



# **oyster**<sup>™</sup> ESL

self-ligating aesthetic bracket



## **A UNIQUE SELF-LIGATING AESTHETIC BRACKET THAT TRULY MARKS A NEW ERA IN ORTHODONTIC APPLIANCES**

- Manufactured of a strong composite copolymer
- Increased comfort for the patient with no irritation due to rounded corners everywhere, no bracketwings sticking out and no irritating metalligatures that causes pain to the patient
- No elastomeric ligatures that discolours
- Very fast ligating and de-ligating with the unique hinged snap-on cap. The orthodontist or the assistant will experience no pain in hands or joints from twisting ligatures.
- Colour-coding for convenient aligning on the tooth
- Easy identification with a unique marking-system branded in the cap
- Reduced friction as the wire has absolutely free passage when you need it – sliding mechanics is much faster than with conventional brackets
- Convertible – the cap can easily be removed and the bracket can function as a regular twin bracket if necessary
- A unique patented snap-on hinged cap for easy closing and opening
- The specially designed cap-opener makes it easy to open the hinged cap
- Indent in cap for easier opening
- Oyster is equipped with a very effective distal T-hook on the cuspids
- The snap-on caplock is strong enough to withstand all necessary orthodontic forces (see University study on [gestenco.com](http://gestenco.com)).
- Mechanical lock base

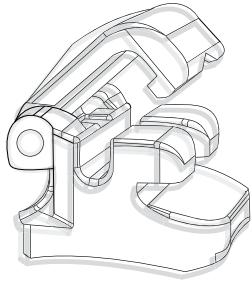

Oyster™ Standard Edgewise						
Type	Description	M/D mm	.018	.022		
Centrals	Upper right/left	4.0	OY-10-44	OY-10-54		
Laterals	Upper right/left	3.0	OY-12-44	OY-12-54		
Cuspids/Bicuspids	Upper right/left	4.0	OY-20-44	OY-20-54		
	Lower right/left					
Anteriors	Lower right/left	3.0	OY-30-44	OY-30-54		

Oyster™ Formula Roth*							
Type	Description	Torque	Ang.	M/D mm	.018	.022	
Centrals	Upper right	+12°	5°	4.0	OY-11-45	OY-11-55	
	left				OY-21-45	OY-21-55	
Laterals	Upper right	+8°	9°	3.0	OY-12-45	OY-12-55	
	left				OY-22-45	OY-22-55	
Cuspids w/hook	Upper right	-2°	9°	4.0	OY-13-45HK	OY-13-55HK	
	left				OY-23-45HK	OY-23-55HK	
Bicuspids	Upper right/left	-7°	0°	4.0	OY-14-45	OY-14-55	
Anteriors	Lower right/left	0°	0°	3.0	OY-30-45	OY-30-55	
Cuspids w/hook	Lower right	-11°	5°	4.0	OY-43-45HK	OY-43-55HK	
	left				OY-33-45HK	OY-33-55HK	
Bicuspids	Lower right/left	-17°	0°	4.0	OY-44-45	OY-44-55	

\* Gestenco Int. does not imply authorization or endorsement by Dr. Roth.

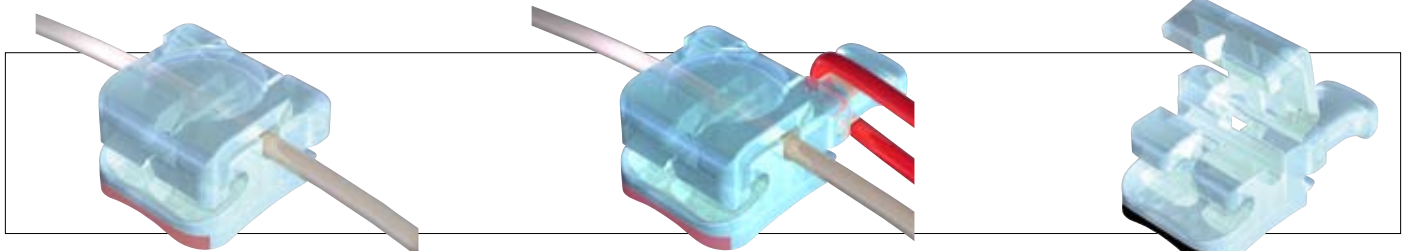

Colour-coding for convenient aligning on the tooth.

Reduced friction as the wire has absolutely free passage when you need it – sliding mechanics is much faster than with conventional brackets.

A unique patented snap-on hinged cap for easy closing and opening.

# *oyster*<sup>TM</sup> ESL

self-ligating aesthetic bracket

OYSTERS AT WORK



**KIT-OY-BOX**

Also available in a box assortment with 5 or 10 cases of Oysterbrackets, corresponding sequence of Imagination wires, a cap opener and a practicing thimble for opening and closing the cap.

**ONE CASE KIT CAROUSEL**



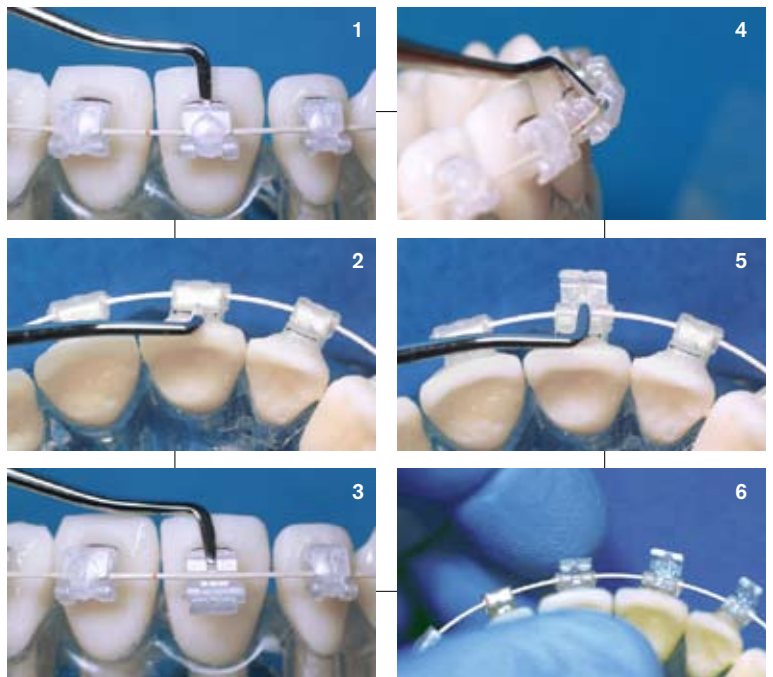

**HOW TO USE THE OYSTER CAP OPENER**

1. Put the cap-opener between the cap and the bracketbase (picture 1 and 2).
2. Apply a light force on the instrument and turn it 45 degrees (picture 3 and 4).
3. The cap opens (picture 5).
4. Close the cap with your finger (picture 6).

# *image*<sup>™</sup>

aesthetics in every case  
and prescription



## THE PERFECT COMBINATION OF AESTHETICS AND CLINICAL PERFORMANCE

Image is made of a special grade polymer enforced with glass-fiber, in order to reinforce the bracket to withstand all necessary orthodontic forces, without losing its flexibility.

### **GOOD LOOKS**

Image stain-resistant material retains an aesthetic appearance throughout treatment. Upper and lower arches can confidentially be bonded, since enamel wear is virtually eliminated when in occlusion.

### **BONDING**

Use your favourite bonding material, the mechanical lock base provides for easy and safe bonding, without the need for additional conditioners.

### **MARKING**

A colour-coding system and placement jigs makes identification and alignment on the tooth real easy.

Image™ Standard Edgewise				
Type	Description	M/D mm	.018	.022
Centrals/Laterals	Upper right/left	3.5	IM-10-44	IM-10-54
Cuspids/Bicuspids	Upper right/left	3.5	IM-20-44	IM-20-54
Anteriors	Lower right/left	2.6	IM-30-44	IM-30-54
Cuspids/Bicuspids	Lower right/left	3.5	IM-40-44	IM-40-54

Image™ Formula Roth*								
Type	Description	Torque	Ang.	Offset	M/D mm	.018	.022	
Centrals	Upper right left	+12°	5°	0°	3.5	IM-11-45	IM-11-55	
						IM-21-45	IM-21-55	
Laterals	Upper right left	+8°	9°	0°	3.5	IM-12-45	IM-12-55	
						IM-22-45	IM-22-55	
Cuspids	Upper right left	-2°	9°	4°M	3.5	IM-13-45	IM-13-55	
						IM-23-45	IM-23-55	
Cuspids w/hook	Upper right left	-2°	9°	4°M	3.5	IM-13-45HK	IM-13-55HK	
						IM-23-45HK	IM-23-55HK	
Bicuspids	Upper right/left	-7°	0°	0°	3.3	IM-14-45	IM-14-55	
Bicuspids w/hook	Upper right/left	-7°	0°	0°	3.3	IM-14-45HK	IM-14-55HK	
Anteriors	Lower right/left	0°	0°	0°	3.0	IM-30-45	IM-30-55	
Cuspids	Lower right left	-11°	5°	2°M	3.5	IM-43-45	IM-43-55	
						IM-33-45	IM-33-55	
Cuspids w/hook	Lower right left	-11°	5°	2°M	3.5	IM-43-45HK	IM-43-55HK	
						IM-33-45HK	IM-33-55HK	
Bicuspids	Lower right/left	-17°	0°	0°	3.3	IM-44-45	IM-44-55	

\* Gestenco Int. does not imply authorization or endorsement by Dr. Roth.

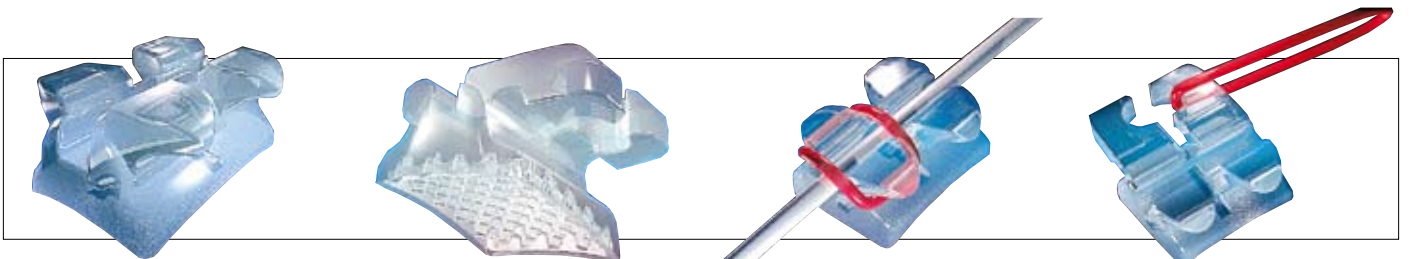

The relative ductility of the material combined with Image contoured compound curvature assures proven fit and bond-strength, without the concern of debonding complications.

The mechanical lock base on the Image bracket provides 150% more bonding surface.

The ability to tie one set of wings in the most severe malocclusions helps provide the necessary rotational control.

Double hook design for easy engagement of intraoral elastics.

Buccal Tubes					
Description	Torque	Offset	M/D mm	.018	.022
Upper right/lower left	-10°	7°D	7.0	IM-67-01	IM-67-01
Upper left/lower right	-10°	7°D	7.0	IM-67-02	IM-67-02

#### BUCCAL TUBES

Glassfiber composite polymer bonding tube with torque-in-base for lower profile and reduced occlusal interference. Two types fits all molars, .018 and .022 archwire slots in the same attachment.

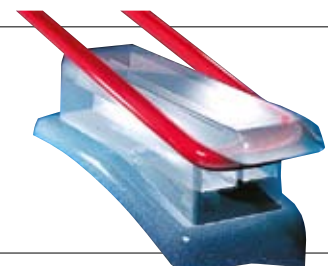

<b>Image™ MBT*-Style</b>						
<b>Type</b>	<b>Description</b>	<b>Torque</b>	<b>Ang.</b>	<b>M/D mm</b>	<b>.022</b>	
Centrals	Upper right left	+17°	4°	3.5	IM-11-52	IM-21-52
Laterals	Upper right left	+10°	8°	3.5	IM-12-52	IM-22-52
Cuspids	Upper right left	-7°	8°	3.5	IM-13-52	IM-23-52
Cuspids w/hook	Upper right left	-7°	8°	3.5	IM-13-52HK	IM-23-52HK
Bicuspids	Upper right/left	-7°	0°	3.3	IM-14-52	
Bicuspids w/hook	Upper right/left	-7°	0°	3.3	IM-14-52HK	
Anteriors	Lower right/left	-6°	0°	3.0	IM-30-52	
Cuspids	Lower right left	-6°	3°	3.5	IM-43-52	IM-33-52
Cuspids w/hook	Lower right left	-6°	3°	3.5	IM-43-52HK	IM-33-52HK
Bicuspids	Lower right/left	-17°	0°	3.3	IM-44-52	

\*MBT is a registered trademark by 3M/Unitek. Gestencos version of the McLaughlin, Bennett and Trevisi prescription is not intended to be a duplication of, nor an endorsement by these doctors and such endorsement is not implied by the use of this term.

<b>Image™ Ricketts Bioprogressive*</b>						
<b>Type</b>	<b>Description</b>	<b>Torque</b>	<b>Ang.</b>	<b>M/D mm</b>	<b>.018</b>	
Centrals	Upper right left	+22°	0°	3.5	IM-11-47	IM-21-47
Laterals	Upper right left	+14°	8°	3.5	IM-12-47	IM-22-47
Cuspids	Upper right left	+7°	5°	3.5	IM-13-47	IM-23-47
Bicuspids	Upper right/left	0°	0°	3.3	IM-14-47	
Anteriors	Lower right/left	0°	0°	3.0	IM-30-47	
Cuspids	Lower right left	+7°	5°	3.5	IM-43-47	IM-33-47
Bicuspids	Lower right/left	0°	0°	3.5	IM-44-47	

<b>Image™ Formula Hilgers*</b>						
<b>Type</b>	<b>Description</b>	<b>Torque</b>	<b>Ang.</b>	<b>M/D mm</b>	<b>.018</b>	
Centrals	Upper right left	+22°	5°	3.5	IM-11-49	IM-21-49
Laterals	Upper right left	+14°	8°	3.5	IM-12-49	IM-22-49
Cuspids	Upper right left	+7°	5°	3.5	IM-13-49	IM-23-49
Bicuspids	Upper right/left	-7°	0°	3.3	IM-14-49	
Anteriors	Lower right/left	0°	0°	3.0	IM-30-49	
Cuspids	Lower right left	+7°	5°	3.5	IM-43-49	IM-33-49
1st Bicuspids	Lower right/left	-11°	0°	3.3	IM-44-49	
2nd Bicuspids	Lower right/left	-17°	0°	3.3	IM-45-49	

\* Gestenco Int. does not imply authorization or endorsement by Dr. Hilgers and Rocky Mountain Orthodontics.

# solo™

A bio-aesthetic single system

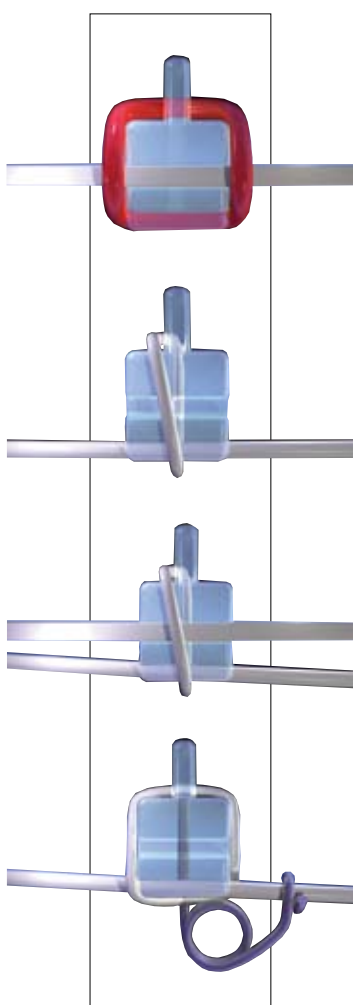

Solo is a glassfiber composite polymer bracket with archwire slots that makes it possible to combine tipping and translation. Efficiently applied minimum force will rapidly open bites and speed treatment. The gingival slot with its elliptical base makes tipping techniques very efficient. The archwire may be secured with pins, ligature ties, wire or springs. The vertical slot accepts auxiliaries for securing the archwire. Solo is available in the Roth prescription and Standard Edgewise, with .018 or .022 slots.

Solo™ Standard Edgewise				
Type	Description	M/D mm	.018	.022
Centrals/ Laterals	Upper right/left Lower right/left	2.6	SO-10-44	SO-10-54
Cuspids/Bicus- pids	Upper right/left Lower right/left	2.6	SO-20-44	SO-20-54

Solo™ Formula Roth*						
Type	Description	Torque	Ang.	M/D mm	.018	.022
Centrals	Upper right left	+12°	5°	2.6	SO-11-45 SO-21-45	SO-11-55 SO-21-55
Laterals	Upper right left	+8°	9°	2.6	SO-12-45 SO-22-45	SO-12-55 SO-22-55
Cuspids	Upper right left	-2°	9°	2.6	SO-13-45 SO-23-45	SO-13-55 SO-23-55
Bicuspids	Upper right/left	-7°	0°	2.6	SO-14-45	SO-14-55
Anteriors	Lower right/left	0°	0°	2.6	SO-30-45	SO-30-55
Cuspids	Lower right left	-11°	5°	2.6	SO-43-45 SO-33-45	SO-43-55 SO-33-55
Bicuspids	Lower right/left	-17°	0°	2.6	SO-44-45	SO-44-55

\* Gestenco Int. does not imply authorization or endorsement by Dr. Roth.

# *blonde*<sup>™</sup>

Glass-reinforced composite polymer bracket

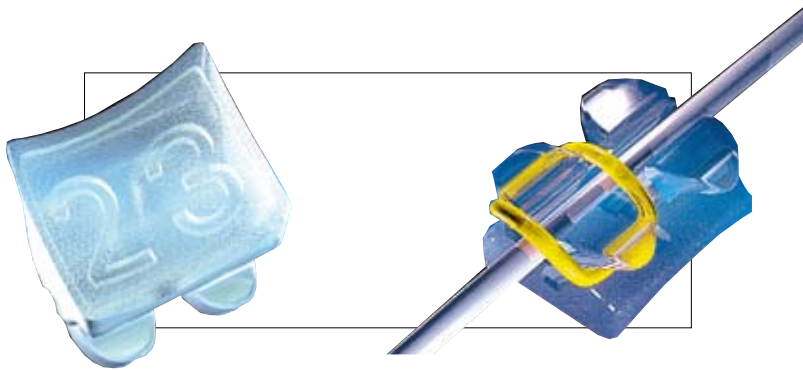

Blonde offers both the strength and the good looks that will give you and your patient great satisfaction. The Blonde bracket is available in Standard Edgewise .018 and .022, and in a complete and true "Straight-Arch" formula with:

- Ins and outs
- Torque in base
- Rhomboid shape for easy bracketplacement
- Rotation and anti-rotation offsets
- Hooks available on cuspids/bicuspid
- Mechanical/chemical lock bonding base
- Each bracket is identified, according to the FDI system, with engraved numbers in the bracketbase

<b>Blonde™ Standard Edgewise</b>				
<b>Type</b>	<b>Description</b>	<b>M/D mm</b>	<b>.018</b>	<b>.022</b>
Centrals/Laterals	Upper right/left	3.5	BL-10-44	BL-10-54
Cuspids/Bicus-pids	Upper right/left	3.5	BL-20-44	BL-20-54
Anteriors	Lower right/left	2.6	BL-30-44	BL-30-54
Cuspids/Bicus-pids	Lower right/left	3.5	BL-40-44	BL-40-54

<b>Blonde™ Formula Roth*</b>							
<b>Type</b>	<b>Description</b>	<b>Torque</b>	<b>Ang.</b>	<b>Offset</b>	<b>M/D mm</b>	<b>.018</b>	<b>.022</b>
Centrals	Upper right	+12°	5°	0°	3.5	BL-11-45	BL-11-55
	left					BL-21-45	BL-21-55
Laterals	Upper right	+8°	9°	0°	3.5	BL-12-45	BL-12-55
	left					BL-22-45	BL-22-55
Cuspids	Upper right	-2°	9°	4°M	3.5	BL-13-45	BL-13-55
	left					BL-23-45	BL-23-55
Cuspids w/hook	Upper right	-2°	9°	4°M	3.5	BL-13-45HK	BL-13-55HK
	left					BL-23-45HK	BL-23-55HK
Bicuspids	Upper right/left	-7°	0°	0°	3.3	BL-14-45	BL-14-55
Bicuspids w/hook	Upper right/left	-7°	0°	0°	3.3	BL-14-45HK	BL-14-55HK
Anteriors	Lower right/left	0°	0°	0°	3.0	BL-30-45	BL-30-55
Cuspids	Lower right	-11°	5°	2°M	3.5	BL-43-45	BL-43-55
	left					BL-33-45	BL-33-55
Cuspids w/hook	Lower right	-11°	5°	2°M	3.5	BL-43-45HK	BL-43-55HK
	left					BL-33-45HK	BL-33-55HK
Bicuspids	Lower right/left	-17°	0°	0°	3.3	BL-44-45	BL-44-55

\* Gestenco Int. does not imply authorization or endorsement by Dr. Roth.

# BLONDE RAINBOW EDITION™

Put some colours into your patients smile with coloured blonde



Most young patients prefer coloured ligatures. Why not go all the way and offer them coloured brackets like the Blonde Rainbow Edition, a composite bracket in pink, blue, red and pearl violet.

## BLONDE RAINBOW

- You don't need an assortment of coloured ligatures – only one transparent type will do.
- Goes particularly well with Imagination™, toothcoloured arch wires.
- Puts fashion into orthodontics – great patient motivator.

## GLASS-REINFORCED COMPOSITE POLYMER BRACKET

Blonde offers both the strength and the good looks that will give you and your patient great satisfaction. The Blonde bracket is available in Standard Edgewise and in a complete and true "Straight-Arch" formula with:

- Ins and outs
- Torque in base
- Rhomboid shape for easy bracketplacement
- Rotation and anti-rotation offsets
- Hooks on cuspids U/L/bicuspid Upper
- Mechanical/chemical lock bonding base
- Each bracket is identified, according to the FDI system, with engraved numbers in the bracketbase

**Blue****Pearl Violet****Pink****Red**

<b>Blonde Rainbow formula Roth</b> - Available in slot .018 and .022						
<b>Type</b>	<b>Description</b>	<b>Torque</b>	<b>Ang</b>	<b>Offset</b>	<b>M/D mm</b>	
Centrals	Upper right/left	+12°	5°	0°	3,5	
Laterals	Upper right/left	+8°	9°	0°	3,5	
Cuspids w/hook	Upper right/left	-2°	9°	4°M	3,5	
Bicuspids w/hook	Upper right/left	-7°	0°	0°	3,3	
Anteriors	Lower right/left	0°	0°	0°	3	
Cuspids w/hook	Lower right/left	-11°	5°	2°M	3,5	
Bicuspids	Lower right/left	-17°	0°	0°	3,3	

\*Gestenco Int. does not imply authorization or endorsement by Dr. Roth

# phantom™

Transparent Lingual Direct Bonding Self-Ligating Bracket

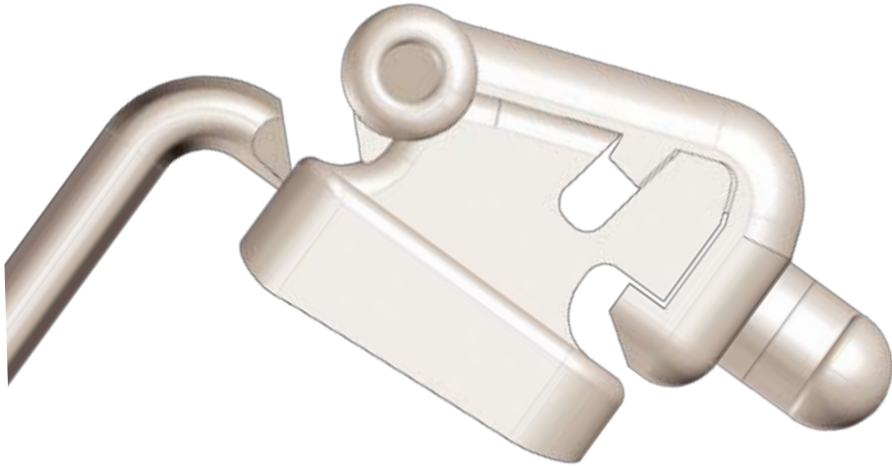

## WHY A TRANSPARENT LINGUAL BRACKET?

- No dark shades from brackets visible through teeth
- Truly invisible – also on lowers



## "THE ÖRTENDAHL LINGUAL SYSTEM"

- Self-ligating
- Direct bonding with fixed placement-jig guarantees correct position
- Interactive in final stage
- Optional tubes on premolars
- Manufactured in a transparent special medical grade polymer
- Great patient comfort from protective closing door

Incisors and Cuspids

Premolars

Premolars and Molars



### Phantom Pearl chain

Continuous	PC-00-01
Short	PC-00-02
Long	PC-00-03

### Phantom /Duett cap opener

PH-CO-01
----------

### Phantom lingual bracket

Type	Description	Torque	Ang.	M/D mm	.018
Cent./ Lat. /Cusp.	Upper/lower Right/left	60°	0°	4.2	PH-10-46
Bicuspids	Upper /lower Right/left	10°	0°	4.2	PH-20-46
Tube	Upper/lower	60°	0°	3.5	PH-67-00

### Heat treated mushroom shape

.016	Upper	Lower
Small	PH-NT-116S	PH-NT-216S
Medium	PH-NT-116M	PH-NT-216M
Large	PH-NT-116L	PH-NT-216L
.016x.022 NiTi	Upper	Lower
Small	PH-NT-1622S	PH-NT-2622S
Medium	PH-NT-1622M	PH-NT-2622M
Large	PH-NT-1622L	PH-NT-2622L
.016x.022 TiMb	PH-TI-1622	PH-TI-2622
.016x.022 SS	PH-SS-1622	PH-SS-2622

### Convenient starter kit



#### Contents

- Brackets and tubes
- Selected wire sequence
- Special thin elastic chains
- Instrument for door opening and wire-placement
- Practise thimble



# Vitrine™

## Ceramic Brackets

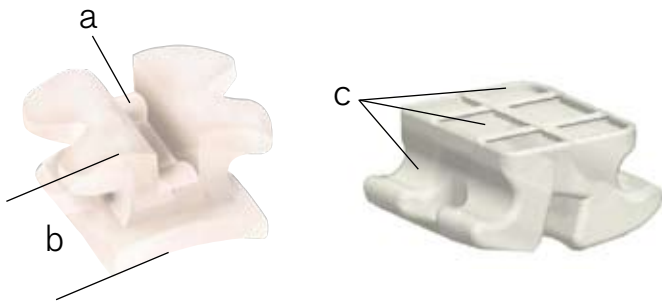

### Mechanical performance

- One-body manufacturing injection process solves the problem of brittleness and breakage and guarantees the precise slot.
- The point-point contact <sup>a</sup> between the wire and slot creates lower friction and makes metal slots unnecessary.
- Lower profile <sup>b</sup> than metal-lined ceramics.
- Undercut structure in base <sup>c</sup> enables optimal bonding strength and easy debonding.

### Physical characteristics

- High breakage resistance and torque strength are achieved from the dense polycrystalline structure.
- Good biocompatibility, colour stability and no discolouration.

### What patients will find...

- **Aesthetics**  
A more transparent and invisible appearance.
- **Comfortable**  
Smooth surface, lower profile, smart hooks and perfect rounded facial contours enhance comfort.

### What orthodontists will find...

- **Easy identification**  
Colour-marks on the gingival distal tie-wings identify the four quadrants.
- **Accurate placement**  
Anatomically contour-compound base for fast and accurate fit.



<b>Vitrine™ Formula Roth*</b>					
<b>Type</b>	<b>Description</b>	<b>Torque</b>	<b>Ang.</b>	<b>.018</b>	<b>.022</b>
Centrals	Upper right left	+12°	5°	VI-11-45 VI-21-45	VI-11-55 VI-21-55
Laterals	Upper right left	+8°	9°	VI-12-45 VI-22-45	VI-12-55 VI-22-55
Cuspids w/hook	Upper right left	-0°	11°	VI-13-45HK VI-23-45HK	VI-13-55HK VI-23-55HK
Bicuspids	Upper right/left	-7°	0°	VI-14-45	VI-14-55
Bicuspids w/hook	Upper right left	-7°	0°	VI-14-45HK VI-24-45HK	VI-14-55HK VI-24-55HK
Anteriors	Lower right/left	-1°	0°	VI-30-45	VI-30-55
Cuspids w/hook	Lower right left	-11°	5°	VI-43-45HK VI-33-45HK	VI-43-55HK VI-33-55HK
1st Bicuspids	Lower right/left	-17°	0°	VI-44-45	VI-44-55
1st Bicuspids w/hook	Lower right left	-17°	0°	VI-44-45HK VI-34-45HK	VI-44-55HK VI-34-55HK
2nd Bicuspids	Lower right/left	-22°	0°	VI-45-45	VI-45-55
2nd Bicuspids w/hook	Lower right left	-22°	0°	VI-45-45HK VI-35-45HK	VI-45-55HK VI-35-55HK

\* Gestenco Int. does not imply authorization or endorsement by Dr. Roth.

<b>Vitrine™ MBT*-Style</b>					
<b>Type</b>	<b>Description</b>	<b>Torque</b>	<b>Ang.</b>	<b>.018</b>	<b>.022</b>
Centrals	Upper right left	+17°	4°	VI-11-52 VI-21-52	VI-11-52 VI-21-52
Laterals	Upper right left	+10°	8°	VI-12-52 VI-22-52	VI-12-52 VI-22-52
Cuspids with hook	Upper right left	-7°	8	VI-13-52HK VI-23-52HK	VI-13-52HK VI-23-52HK
Bicuspids with hook	Upper right left	-7°	0°	VI-14-52HK VI-24-52HK	VI-14-52HK VI-24-52HK
Anteriors	Lower right/left	-6°	0°	VI-30-52	VI-30-52
Cuspids with hook	Lower right left	-6°	3°	VI-43-52HK VI-33-52HK	VI-43-52HK VI-33-52HK
1st Bicuspids with hook	Lower right left	-12°	0°	VI-44-52HK VI-34-52HK	VI-44-52HK VI-34-52HK
2nd Bicuspids w/hook	Lower right left	-17°	0°	VI-45-52HK VI-35-52HK	VI-45-52HK VI-35-52HK

\*MBT is a registered trademark by 3M/Unitek. Gestenco's version of the McLaughlin, Bennett and Trevisi prescription is not intended to be a duplication of, nor an endorsement by these doctors and such endorsement is not implied by the use of this term.

# BITE-BUMPER™

deep bite without trauma

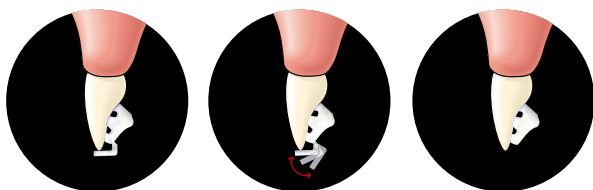

1. Put the placement-jig against the incisal edge
2. Remove the jig
3. Bite-Bumper ready

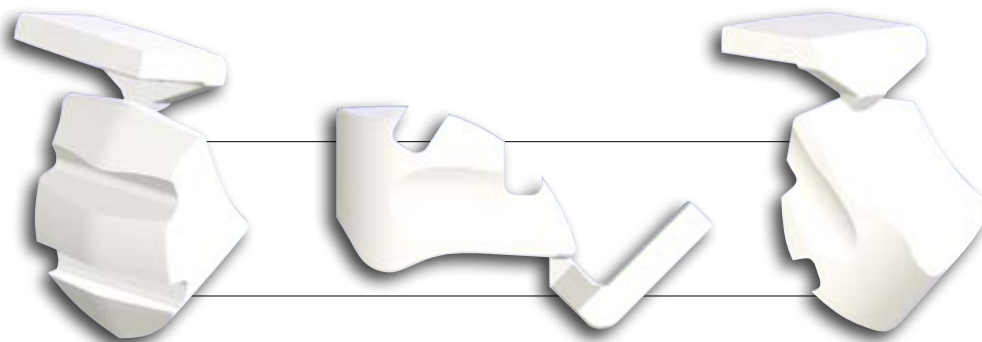

<b>Bite-Bumper™</b>	
Description	Catalogue No.
Bite-Bumper (in packs of 10)	BB-00-01

Bite-Bumpers work in deep bite cases by allowing the anteriors to ride up and out of occlusion. The Bite-Bumpers eliminate bond failures of brackets and are especially valuable with ceramic or self-ligating brackets.

The unique fixed "placement-jig" guarantees the correct height on the lingual of the tooth and makes sure the two Bite-Bumpers are 100 % parallel.

The Bite-Bumpers are made of a composite polymer that is more comfortable, aesthetic and will increase biocompatibility in nickel sensitive patients.

Bite-Bumpers are bonded in the same manner as metal or ceramic brackets. The Bite-Bumpers have a slotted mechanical bonding base.

The placement-jig can easily be removed by hand or by a cutting instrument after bonding - see illustration.

# LIP AND CHEEK RETRACTORS



Lip Retractor made of autoclavable plastic, ideal for occlusal photography as it holds the lips out of the way during photo sessions or bonding.

Imagine Lip retractor	
Description	Catalogue No.
LR-00-01	Adult size
LR-00-02	Child size

## CHEEK RETRACTOR

Includes extensions which may be held by the patient. Soft material for patient comfort. Autoclavable.



### Cheek Retractor

Description	Catalogue No.
Cheek Retractor	CR-00-01

# SmartBond<sup>®</sup>

The "superglue" in orthodontics  
and oral surgery



SmartBond is a completely unique approach to bonding. A true one-step adhesive that allows you to bond brackets, buccal tubes and other attachments in a **wet field**, without the use of a light source or additional primers.

Other features:

- Biocompatible
- Allergy-tested

- Moisture activated
- Bonds on composite and porcelain surfaces
- No bad taste or smell for the patient
- No discolouration throughout treatment
- Bonds on plastic, metal and ceramic attachments
- \* Clinically proven efficiency for bonding of impacted canines

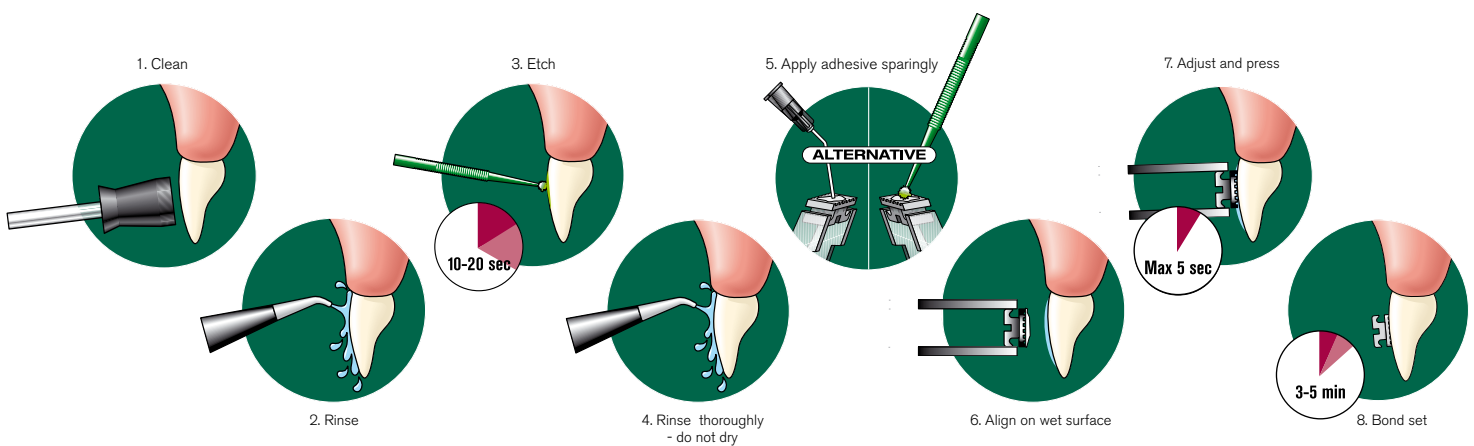

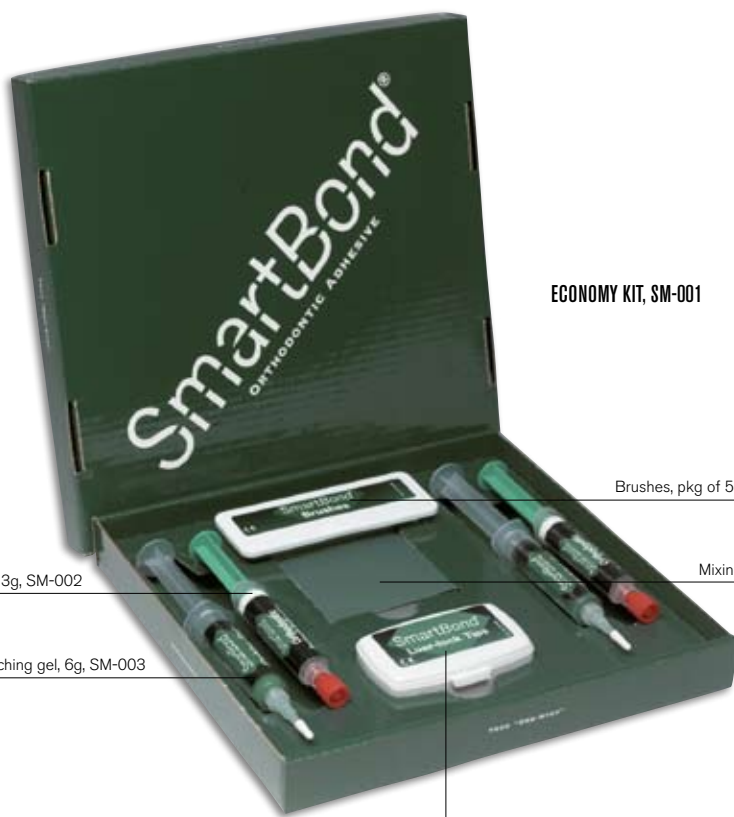

Instant adhesive, 3g, SM-002

Etching gel, 6g, SM-003

Brushes, pkg of 50, SM-004

Mixing pad, SM-006

Luer-lock tips, pkg of 40, SM-005

TRIAL KIT, SM-010



ECONOMY KIT, SM-001

SmartBond products	
Description	Catalogue No.
Trial-kit, 1g	SM-010
Mini-kit, 3g	SM-000
Economy kit, 6g	SM-001
Instant adhesive, 3g	SM-002
Etching gel, 6g	SM-003
Brushes, pkg of 50	SM-004
Luer-lock tips, pkg of 40	SM-005
Mixing pad	SM-006

# SmartBond LC<sup>®</sup>

Light cure bonding adhesive



- For routine bonding 5 to 5
- 1st and 2nd molar bonding
- Exposed and high cuspid bonding
- Works with water, saliva or blood
- After etching, it's simply paste and light
- No primers or conditioners that turns yellow after a while
- Bonds in a wet or dry field - your option
- Dual-cure, light and/or selfcure
  - insures complete polymerization
  - fills any irregular pockets between base & enamel
- Works with metal, plastic and ceramic brackets

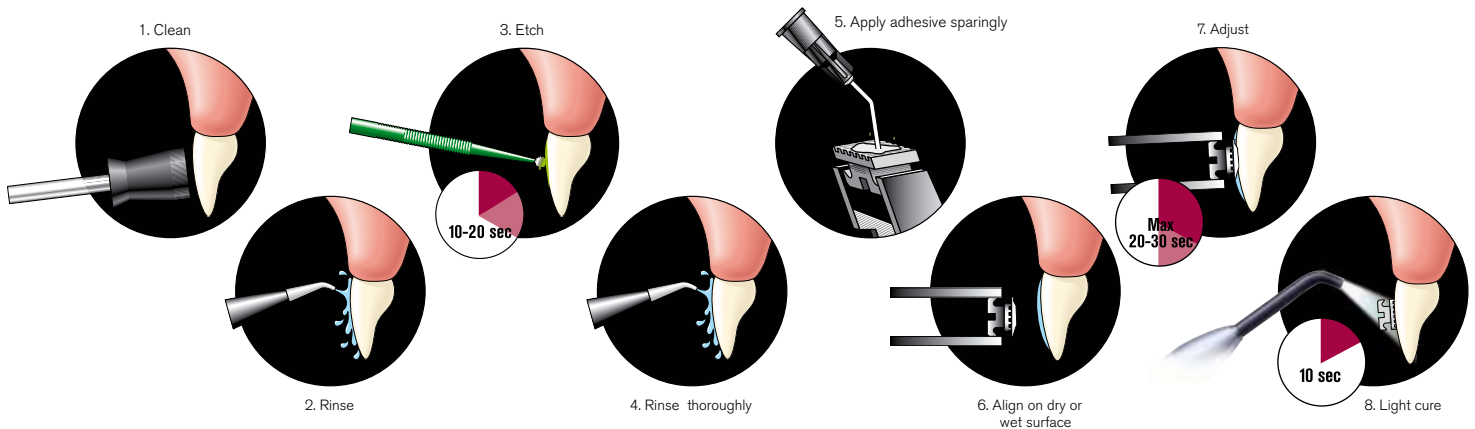

SmartBond LC products	
Description	Catalogue no.
Economy kit, 3g	SM-300-LC
Mini-kit, 1g	SM-100-LC
Etching gel, 6g	SM-003
Brushes, pkg of 50	SM-004
Flowthru tips, pkg of 30	SM-105-LC
Mixing pad	SM-006

SMARTBOND LC MINI-KIT  
SM-100-LC



SMARTBOND LC ECONOMY KIT  
SM-300-LC



# IMAGINATION™

## Tooth-Coloured Archwires



### EPOXY COATED TOOTH-COLOURED ARCHWIRES

...with a superelastic NiTi or stainless steel core. Imagination offers very low friction when used with Image, Oyster ESL 2.0, Blonde, Rainbow and Solo or any ceramic, metal or plastic bracket (see University reports on [gestenco.com](http://gestenco.com)).

- Superior wear resistance and colour stability
- Retains superelastic qualities
- More natural looking than white coatings
- The only complete aesthetic wire range for a full treatment
- Available in Straight-wire and MBT\*-style archforms
- Also available with reverse curve of spee



Imagination with Oyster ESL 2.0 brackets



Straight-wire archform

Straight-Wire Archform		Nickel-Titanium (units of 10)		Stainless Steel (units of 10)	
Coated Wire Size	Upper	Lower	Upper	Lower	Lower
.012	IM-NT-112	IM-NT-212	N/A	N/A	N/A
.014	IM-NT-114	IM-NT-214	IM-SS-114	IM-SS-214	IM-SS-214
.016	IM-NT-116	IM-NT-216	IM-SS-116	IM-SS-216	IM-SS-216
.018	IM-NT-118	IM-NT-218	IM-SS-118	IM-SS-218	IM-SS-218
.020	IM-NT-120	IM-NT-220	IM-SS-120	IM-SS-220	IM-SS-220
.016x.022	IM-NT-1622	IM-NT-2622	IM-SS-1622	IM-SS-2622	IM-SS-2622
.017x.025	IM-NT-1725	IM-NT-2725	IM-SS-1725	IM-SS-2725	IM-SS-2725
.018x.018	IM-NT-1818	IM-NT-2818	IM-SS-1818	IM-SS-2818	IM-SS-2818
.018x.025	IM-NT-1825	IM-NT-2825	IM-SS-1825	IM-SS-2825	IM-SS-2825
.019x.025	IM-NT-1925	IM-NT-2925	IM-SS-1925	IM-SS-2925	IM-SS-2925
.020x.020	IM-NT-2020	IM-NT-3020	IM-SS-2020	IM-SS-3020	IM-SS-3020
.021x.025	IM-NT-2125	IM-NT-3125	IM-SS-2125	IM-SS-3125	IM-SS-3125



Reverse curve of spee

Nickel-Titanium Reverse Curve (units of 10)		
Coated Wire Size	Upper	Lower
.012	IM-RC-112	IM-RC-212
.014	IM-RC-114	IM-RC-214
.016	IM-RC-116	IM-RC-216
.018	IM-RC-118	IM-RC-218
.020	IM-RC-120	IM-RC-220
.016x.022	IM-RC-1622	IM-RC-2622
.017x.025	IM-RC-1725	IM-RC-2725
.018x.018	IM-RC-1818	IM-RC-2818
.018x.025	IM-RC-1825	IM-RC-2825
.019x.025	IM-RC-1925	IM-RC-2925
.020x.020	IM-RC-2020	IM-RC-3020
.021x.025	IM-RC-2125	IM-RC-3125



MBT\*-style archform

MBT*-Style Archform		Nickel-Titanium (units of 10)		Stainless Steel (units of 10)	
Coated Wire Size	Upper	Lower	Upper	Lower	Lower
.012	IM-NT-412	IM-NT-512	N/A	N/A	N/A
.014	IM-NT-414	IM-NT-514	IM-SS-414	IM-SS-514	IM-SS-514
.016	IM-NT-416	IM-NT-516	IM-SS-416	IM-SS-516	IM-SS-516
.018	IM-NT-418	IM-NT-518	IM-SS-418	IM-SS-518	IM-SS-518
.020	IM-NT-420	IM-NT-520	IM-SS-420	IM-SS-520	IM-SS-520
.016x.022	IM-NT-4622	IM-NT-5622	IM-SS-4622	IM-SS-5622	IM-SS-5622
.017x.025	IM-NT-4725	IM-NT-5725	IM-SS-4725	IM-SS-5725	IM-SS-5725
.018x.018	IM-NT-4818	IM-NT-5818	IM-SS-4818	IM-SS-5818	IM-SS-5818
.018x.025	IM-NT-4825	IM-NT-5825	IM-SS-4825	IM-SS-5825	IM-SS-5825
.019x.025	IM-NT-4925	IM-NT-5925	IM-SS-4925	IM-SS-5925	IM-SS-5925
.020x.020	IM-NT-4020	IM-NT-5020	IM-SS-4020	IM-SS-5020	IM-SS-5020
.021x.025	IM-NT-4125	IM-NT-5125	IM-SS-4125	IM-SS-5125	IM-SS-5125

\* MBT is a registered trademark by 3M/Unitek.



Coated ligatures IM-CL-12

Coated Ligatures	
Description	Catalog no.
.012	IM-CL-12

The coating adds .002 inches to raw wire size.

# SUPPLIES



## OYSTER CAP OPENER

A double ended instrument with one end specially designed to open the cap on the Oyster brackets, and the other end with a wire director and height gauge.



### Oyster Cap Opener

Description	Catalogue No.
Oyster cap opener	OY-CO-01

## BUCCAL TUBES

Glassfiber composite polymer bonding tube with torque-in-base for lower profile and reduced occlusal interference. Two types fits all molars, .018 and .022 archwire slots in the same attachment.

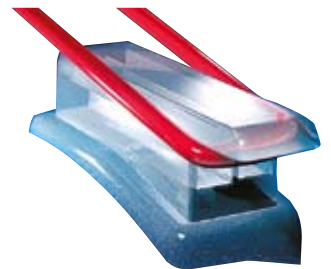

### Buccal Tubes

Description	Torque	Offset	M/D mm	.018	.022
Upper right/lower left	-10°	7°D	7.0	IM-67-01	IM-67-01
Upper left/lower right	-10°	7°D	7.0	IM-67-02	IM-67-02

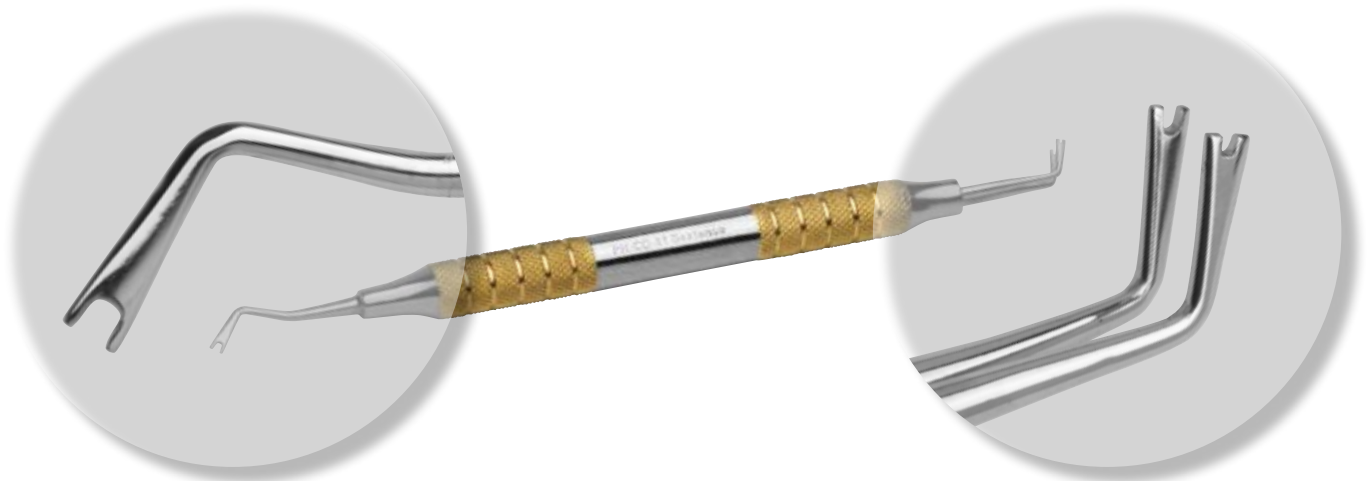

Single fork

Dual forks

**Phantom /Duett cap opener**

PH-CO-01

**MOBERG DISTAL ARCHWIRE BENDER**

Stainless steel construction, one end has a distal arch-wire bender and the opposing end has an angled wire director.



**Moberg Arch Bender**

Description	Catalogue No.
Arch Bender	MO-00-01

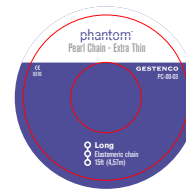

**Phantom Pearl chain**

Continuous	PC-00-01
Short	PC-00-02
Long	PC-00-03



**OVERBITE RULER**

Aluminum ruler for easy measuring of overbite.

**Overbite Ruler**

Description	Catalogue No.
Overbite ruler	OP-11-00

# **GESTENCO**

Gestenco International AB  
P O Box 24067, SE-400 22 Gothenburg, Sweden  
Phone +46 31 81 00 35, Fax +46 31 81 46 55  
[www.gestenco.com](http://www.gestenco.com) / [info@gestenco.com](mailto:info@gestenco.com)

ISO 9001 and  
ISO 13485/CE certified